

Portable Shield Instruction Manual

DANRAY Products LLC
MACHINE SAFEGUARDS AND ACCESSORIES



Thank you for purchasing a Danray Products portable shield. This versatile and durable shield can be used in many machine applications. This quality-made, heavy-duty shield is proudly made in the United States of America.

Portable shields serve two basic functions: (1) they provide a safeguard between individuals and point-of-operation or moving hazards, and (2) they protect individuals from flying chips, sparks, coolant, lubricant, and other particles. When applied properly, they will comply with applicable OSHA and ANSI safety standards.

The enclosed safety sign identifies and warns individuals against specific hazards. Our signs comply with OSHA 29 CFR 1910.145 and the ANSI Z535 series of standards for the design, application, and use of signs, colors, and symbols for accident prevention.

TF 1.866.482.6807 / P 815.262.6667 | 973 Featherstone Road, Unit 115, Rockford, Illinois 61107 | www.danrayproducts.com / service@danrayproducts.com

DANRAY Products LLC
MACHINE SAFEGUARDS AND ACCESSORIES

Copyright © 2013 by Danray Products LLC. All rights reserved.

Manual No. MAN-003

Assembling the Shield

First, peel back and remove the protective masking on the shield. Second, assemble the handle to the shield as illustrated in the drawing to the right. (Note: Be sure to put the flat washers between the shield and locknuts.)

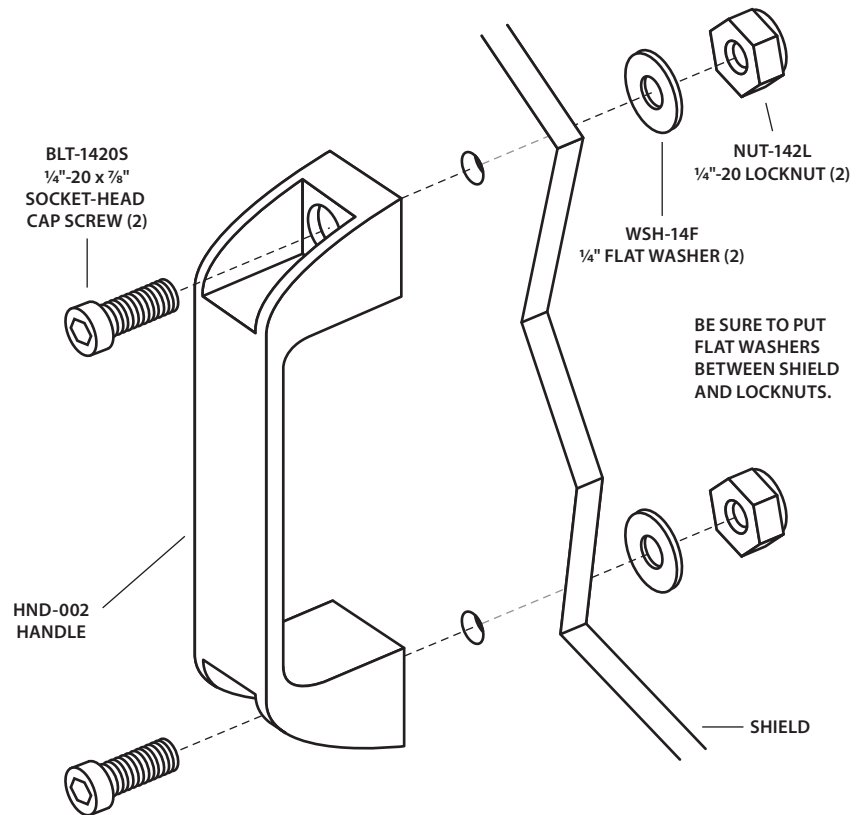

Hook and Fasteners

A hook and fasteners are supplied with each shield. The hook can be mounted in a convenient location for the shield to be stored when not in use.

⚠ WARNING If you are mounting the hook to a surface that has internal components or liquid, be careful not to drill through this surface because it may cause electric shock, leakage, or damage.

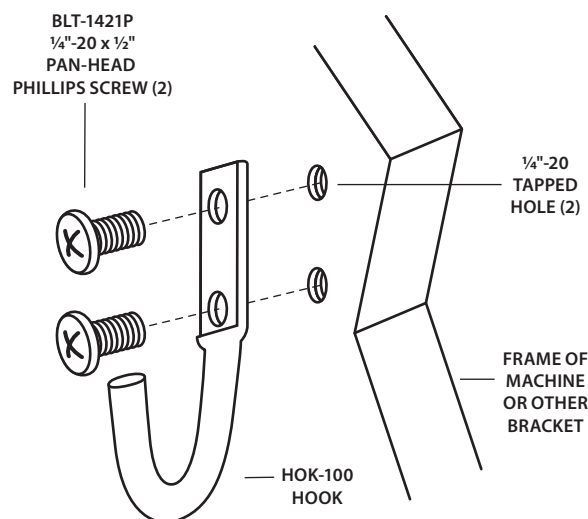

Vise Attachment of SHD-2315MP and SHD-2315MFP

Shield assemblies SHD-2315MP and SHD-2315MFP can be attached to a 6" vise with two furnished ½"-13 x 1" button-head cap screws (most 6" vises have two ½"-13 holes on 3⅞" centers).

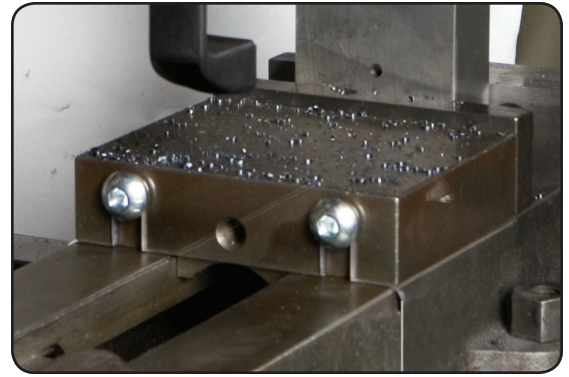
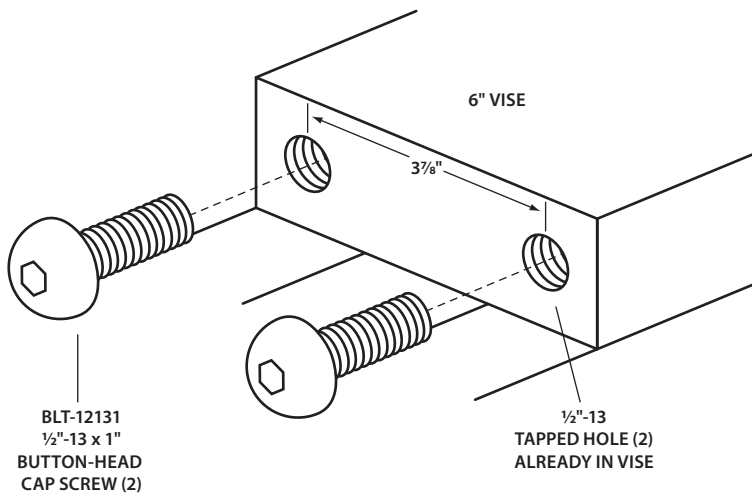

Two ½"-13 x 1" button-head cap screws holding the shield to the vise.



One LBL-002 sign is included with every shield assembly. Affix this sign to a prominent location on the machine so that it is easily seen and understood by individuals in the hazard area.

Additional signs for

other machinery and equipment are available as well as polycarbonate sign backings; contact us by phone, fax, e-mail, or online.

Portable Shield Assemblies

Part No.	Description
SHD-1512FP	Shield Assembly 15¾" W x 12¾" H x ⅜" Thick, Flat
SHD-2315FP	Shield Assembly 23¾" W x 15¾" H x ⅜" Thick, Flat
SHD-2315MFP	Shield Assembly 23¾" W x 15¾" H x ⅜" Thick, Flat With 6" Vise Cutout
SHD-2315MP	Shield Assembly 22" W x 15¾" H x ⅜" Thick, Winged (3" Vertical Wings) With 6" Vise Cutout

Cleaning and Maintaining the Shield

The shield itself is made of a polished, UV-stabilized polycarbonate. To clean the shield, thoroughly rinse it with warm water using a soft cloth or sponge. Then wash it with mild soap or detergent (such as Formula 409, Top Job, Joy, Palmolive Liquid, or Windex) and rinse it thoroughly with clean water. To prevent water spots, dry the shield with a chamois or moist sponge. Avoid cleaning the shield in direct sunlight to prevent streaking.

NOTICE

Do not use abrasive cleaners or harsh solvents for cleaning; this may damage the polycarbonate shield.