

52" and 62" Steel Lathe Chuck Shield Instruction Manual

DANRAY Products LLC
MACHINE SAFEGUARDS AND ACCESSORIES

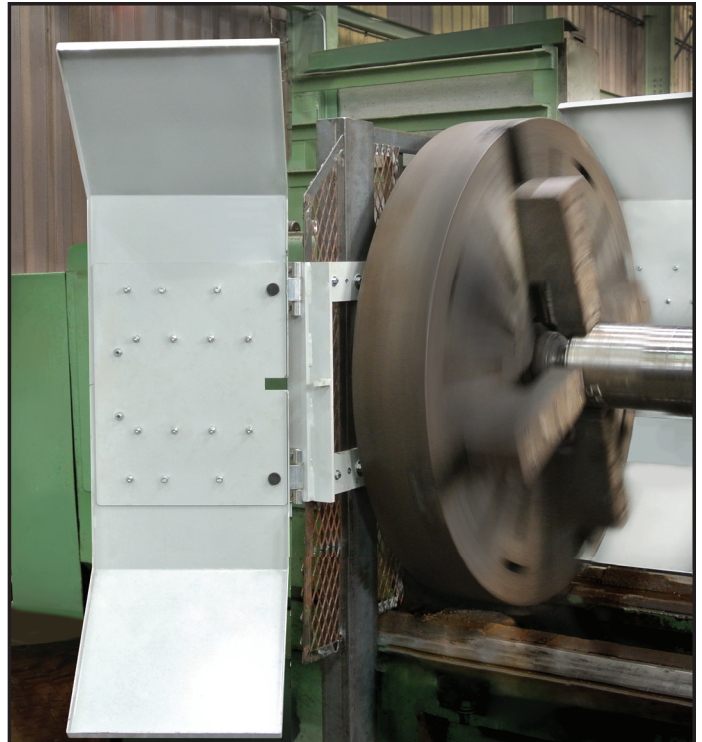

Thank you for purchasing a Danray Products lathe chuck shield. This versatile and durable shield can be used in many machine applications. This quality-made, heavy-duty shield is proudly made in the United States of America.

Lathe chuck shields serve two basic functions: (1) they provide a safeguard between individuals and point-of-operation or rotating hazards, and (2) they protect individuals from flying chips, sparks, coolant, lubricant, and other particles. When applied properly, they will comply with applicable OSHA and ANSI safety standards. If turning is done beyond the chuck shield or if chips fly out from the open ends, additional shields or

guards may be required. For additional shields, see our website or catalog.

The enclosed safety sign identifies and warns individuals against specific hazards. Our signs comply with OSHA 29 CFR 1910.145 and the ANSI Z535 series of standards for the design, application, and use of signs, colors, and symbols for accident prevention.

TF 1.866.482.6807 / P 815.262.6667 | 973 Featherstone Road, Unit 115, Rockford, Illinois 61107 | www.danrayproducts.com / service@danrayproducts.com

DANRAY Products LLC
MACHINE SAFEGUARDS AND ACCESSORIES

Copyright © 2013 by Danray Products LLC. All rights reserved.

Manual No. MAN-010

Assembling and Installing the Shield

The shield is usually mounted either on the front or back of the lathe in the vertical position. You may have purchased two shields (one for the front and one for the back).

The lathe chuck shield assembly includes the shield (three pieces), mounting bracket, hinges, bumpers, handle, fasteners, and a safety sign. To assemble, take all of the components out of the shipping container, remove all protective packaging, and lay them out as illustrated in the drawings below and on the next page. Assemble the three-piece shield and hinges using the fasteners provided. To make sure that all parts will align, do not tighten the fasteners until the shield is completely assembled on the lathe.

Now take the mounting bracket, by itself, and hold it up to the face of the lathe headstock to spot the mounting holes. (Note: If the legs on the mounting bracket are too long, cut them to length.) After spotting the holes, drill and tap $\frac{1}{2}$ "-13 holes in the face of the lathe. Then install the mounting bracket using the fasteners provided. After the mounting bracket is securely attached to the headstock, install the shield by fastening the hinges to the bracket. Due to its weight, doing this may take two individuals, a hoist, or a forklift to position the shield. Align and tighten all fasteners and the installation will be complete.



If you are mounting the shield to a surface that has internal components or liquid, be careful not to drill through this surface because it may cause electric shock, leakage, or damage.

Illustrated Below: Shield Assemblies SHD-6116L and SHD-7416L

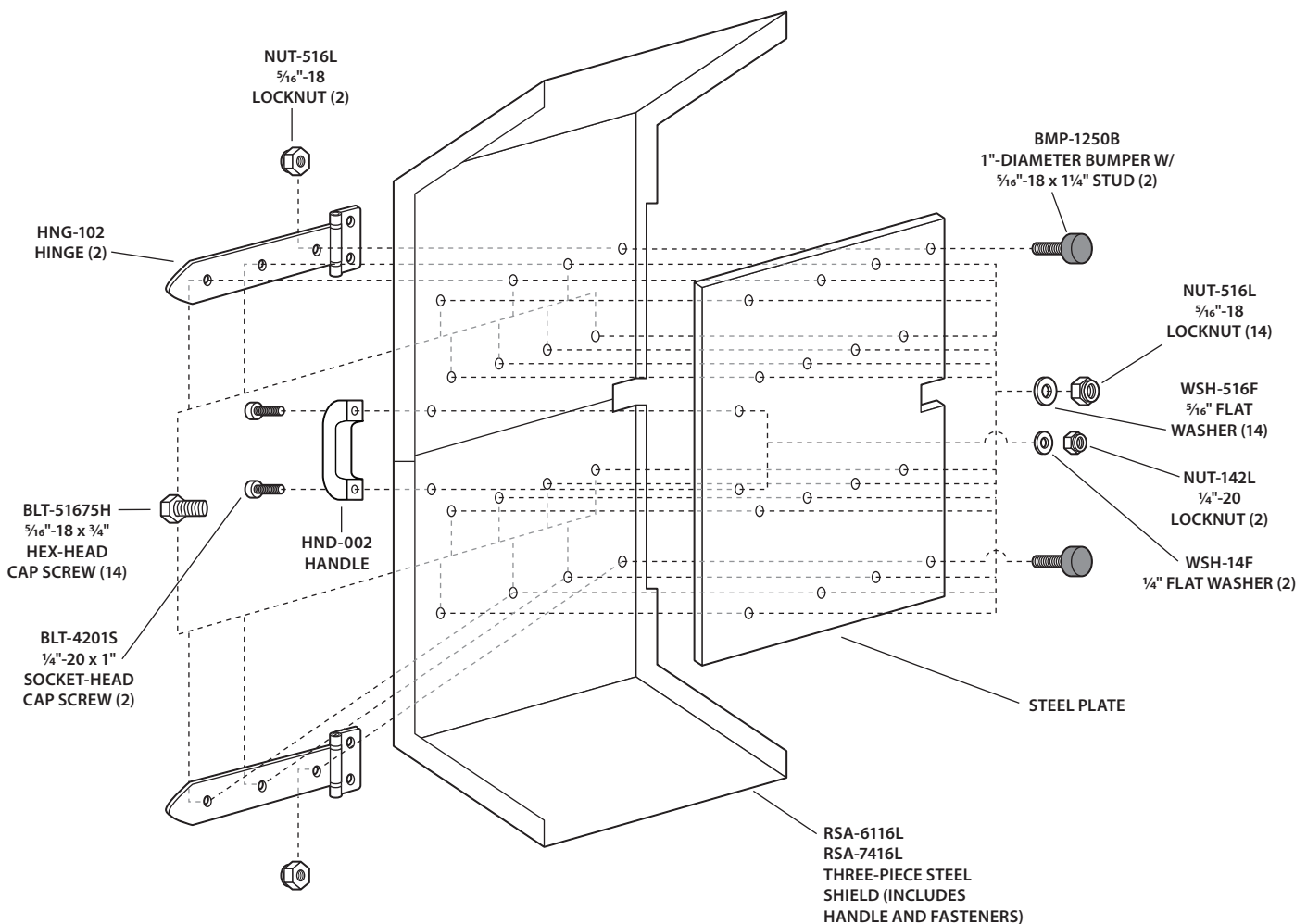

Illustrated Below: Mounting Bracket Assembly

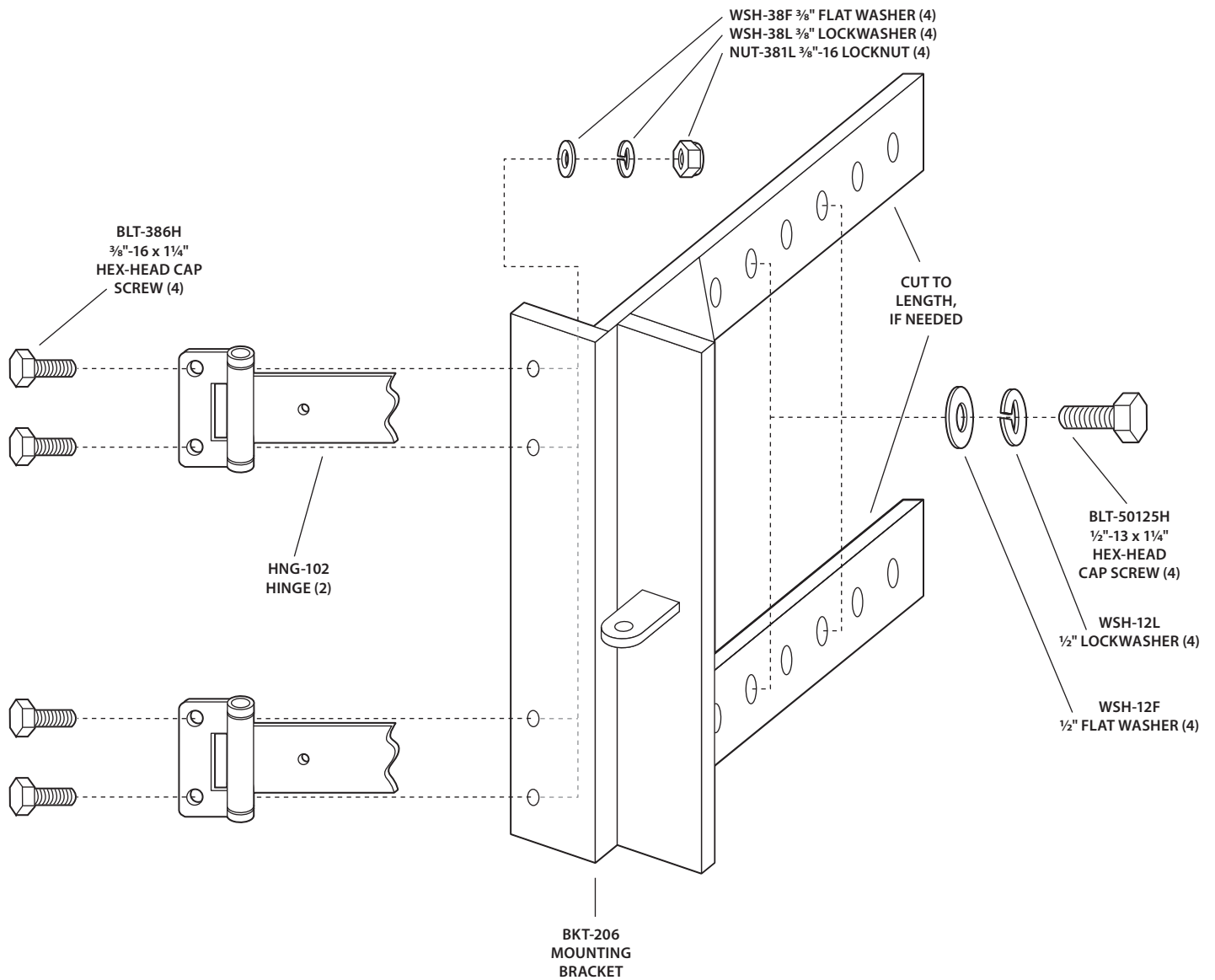

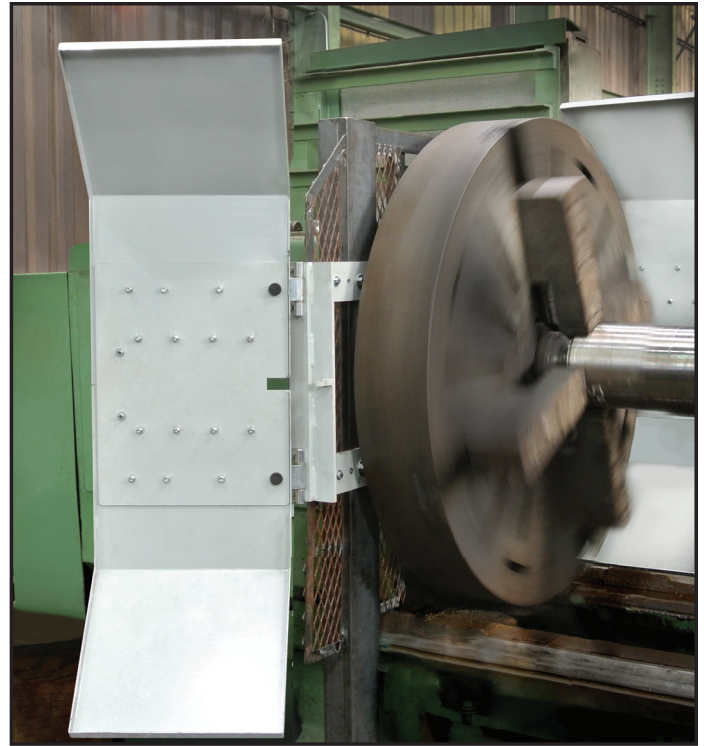

Replacement Shields Only

Part No.	Description
RSA-6116L	Shield Only for Lathe Chuck Diameter of 52" and Smaller
RSA-7416L	Shield Only for Lathe Chuck Diameter of 62" and Smaller



One LBL-005 sign is included with every shield assembly. Affix this sign to a prominent location on the machine so that it is easily seen and understood by individuals in the hazard area. Additional signs for other machinery and equipment are available as well as polycarbonate sign backings; contact us by phone, fax, e-mail, or online.

Part No. LBL-005